

Fort Lee, Virginia

© COPYRIGHT 2009

USED WITHOUT THE CONSENT OF THE DEFENSE
COMMISSARY AGENCY

DATE:	SOLICITATION ISSUE: 2-25-09
-------	-----------------------------

DATE:	CRITERIA ISSUE: 5-28-09
-------	-------------------------

DATE:	
DATE:	

--

DeCA Decor 2009

Component Placement Plan

A1.1

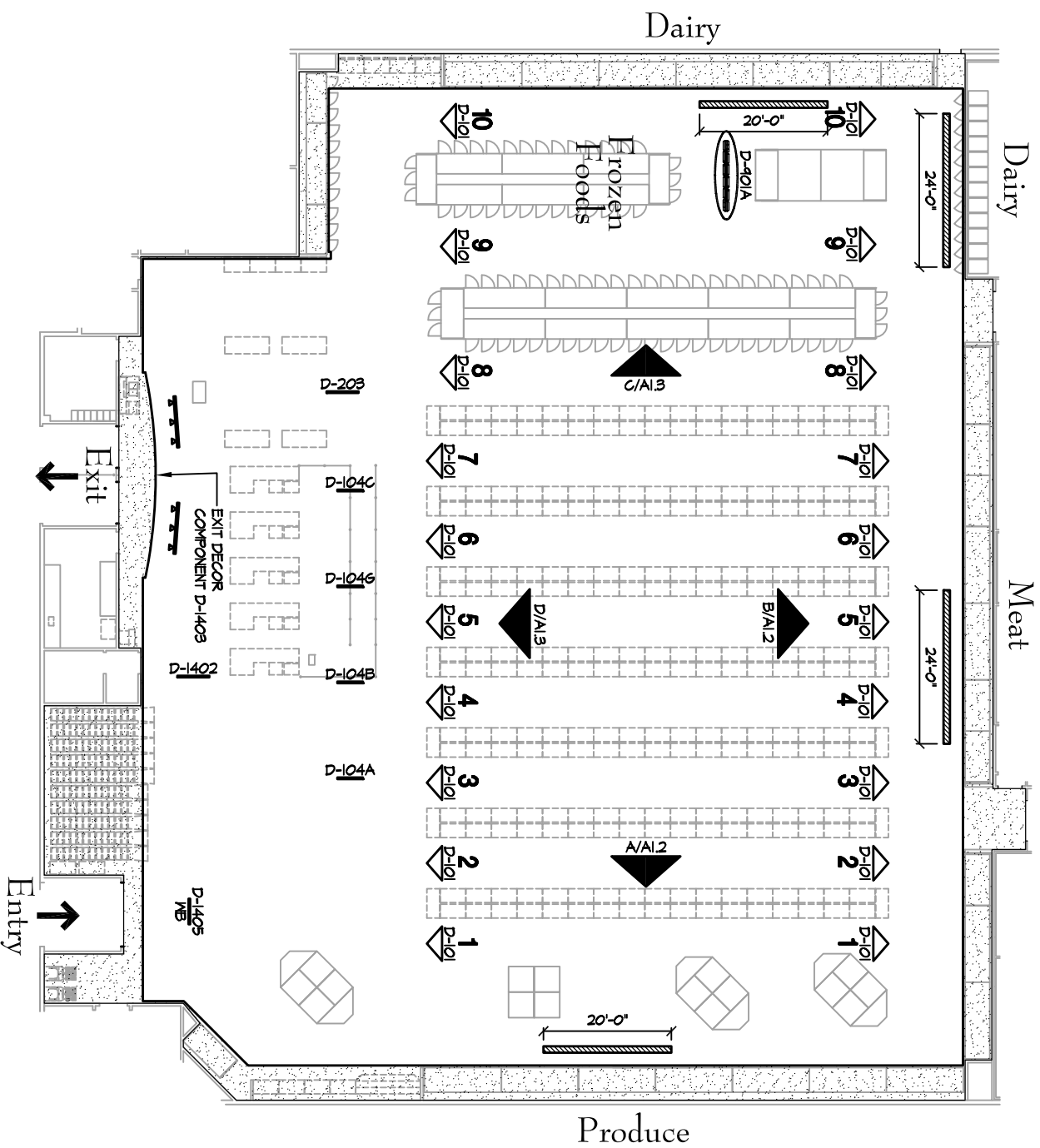

Decor Placement Plan - Class I Store

Decor Components

Qty.	Item No.	Type / Color	Qty.	Banner No.	Type / Color	Qty.	Banner No.	Type / Color	Qty.	Banner No.	Type / Color
20	D-101	Aisle Directory	0	D-104E	Slogan - Green	0	D-706	Sushi	0	D-1301A	Value Aisle
1	D-104A	Slogan - Blue	0	D-104F	Slogan - Blue	1	D-901A	Frozen Foods	0	D-1302	Pricer
1	D-104B	Slogan - Green	1	D-104G	Slogan - Red	0	D-901B	Frozen Foods - Half Sign	1	D-1402	Customer Service
1	D-104C	Slogan - Blue	0	D-104H	Slogan - Red	0	D-1101A	Grab-N-Go	1	D-1405	Welcome
0	D-104D	Slogan - Green	1	D-203	Self Checkout - Red	0	D-1103	Grab-N-Go - T Bracket			

DESIGNER NOTE:

DIMENSIONALLY LOCATE DECOR ELEMENTS, BANNERS AND AISLE DIRECTORIES TO FIT SIZE OF ACTUAL STORE FOOTPRINT

8' TRACK LIGHTING 

COVE LIGHTING -----

WALL WASH 

LIGHTING (CENTER
ON GRAPHIC/LETTERING)